

Parts List

ITEM	QTY	PART NUMBER	DESCRIPTION	TYPE	MASS
1	1	BA-00	TRAPEZE BALANCE		7092.000 lbmass
2	14	BA-01	LOCATING LEVELING FOOT		3.863 lbmass
3	4	CA-01	1/8" OD, 7 X 19 STEEL CABLE		0.036 lbmass
4	1	CA-02	1/8" OD, 7 X 19 STEEL CABLE		0.042 lbmass
5	1	CA-03	1/8" OD, 7 X 19 STEEL CABLE		0.113 lbmass
6	2	CA-04	36" OD STEEL WEIGHT		630.339 lbmass
7	4	CA-05	28" OD LEAD WEIGHT		1518.000 lbmass
8	4	CA-06	10" OD STEEL WEIGHT		390.361 lbmass
9	1	FC-00	FRONT CALIBRATOIN FRAME	WELDMNT	167.456 lbmass
10	1	FP-00	FRONT DRAG PULLEY FRAME	ASSEMBLY	192.145 lbmass
11	1	RC-00	REAR CALIBRATION FRAME	WELDMNT	165.329 lbmass
12	1	RP-00	REAR DRAG PULLEY FRAME	ASSEMBLY	185.719 lbmass
13	4	SP-00	SIDE PULLEY FRAME	ASSEMBLY	83.512 lbmass

NOTES:

- THE TWO DRAG FRAMES MUST BE BOLTED TOGETHER TO PREVENT THEM FROM TIPPING
- THE FRAMES WILL SLIDE TOWARDS THE BALANCE WHEN LOADED. EXTRA MEASURES WILL BE NEEDED TO SUPPLEMENT THE LACK OF ADEQUATE FRICTION
- USES A COMBINATION OF SHACKLES AND COMPRESSION SLEEVE CABLE LOOPS TO SECURE THE CABLES.
- COMPRESS EACH SLEEVE 3 TIMES FOR PROPER STRENGTH

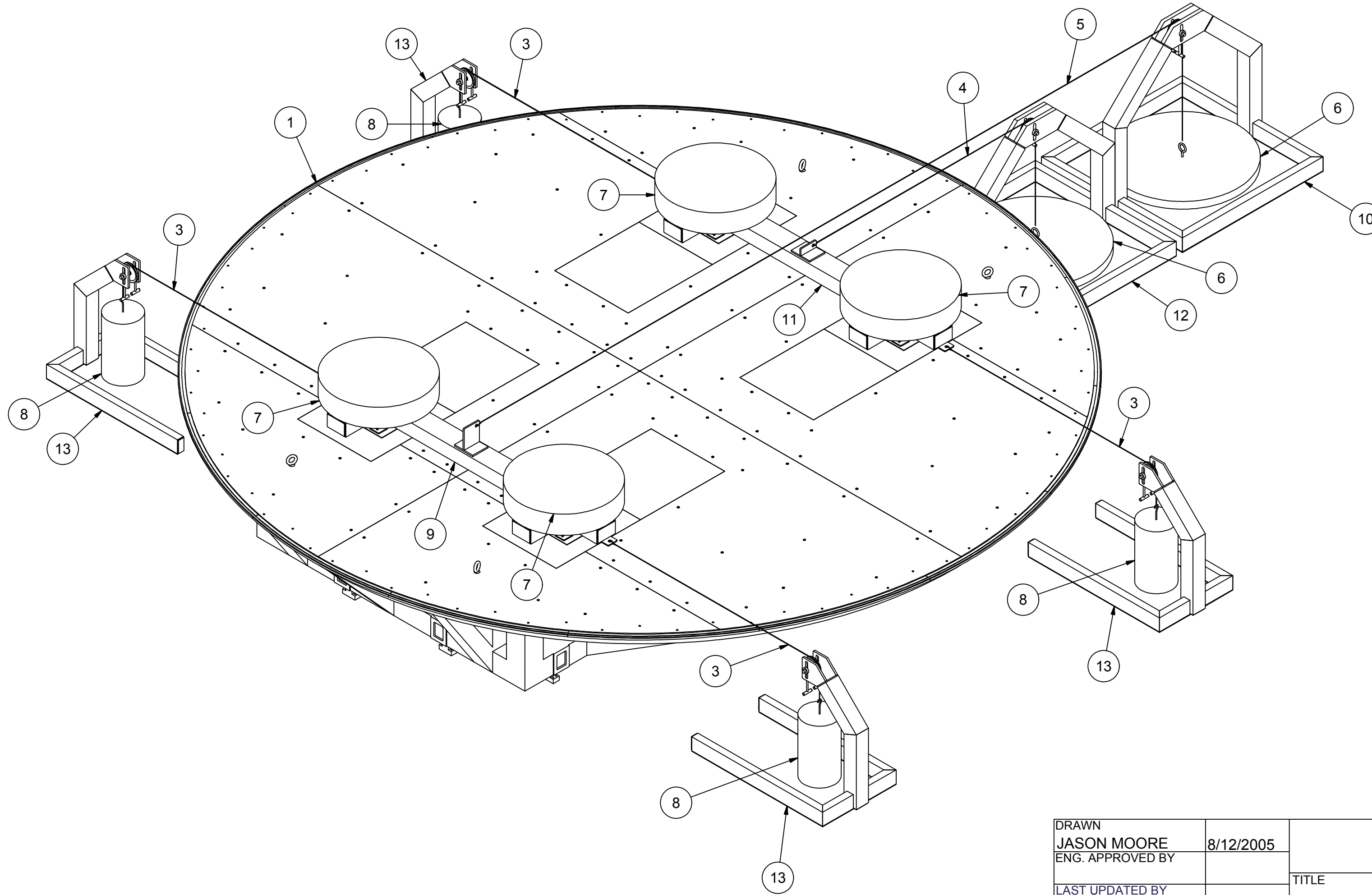

DRAWN JASON MOORE		8/12/2005		OLD DOMINION UNIVERSITY	
ENG. APPROVED BY				LANGLEY FULL SCALE TUNNEL	
LAST UPDATED BY JASON MOORE		8/12/2005		TITLE	
				SIZE	
				C	
				DWG NO	
				CA-00	
				REV	
				SCALE	
				SHEET 1 OF 1	